

2003-04 vehicles with old ECM firmware and 2005-07 vehicles may set an "EGR Flow Insufficient" DTC.

## **EXHAUST COOLANT PIPE** (2003-2007 Ford 6.0L)

\*PLEASE READ ALL INSTRUCTIONS BEFORE INSTALLATION\*

Part #: 1090001 – With Pipe

Part #: 1090006 – With Cap

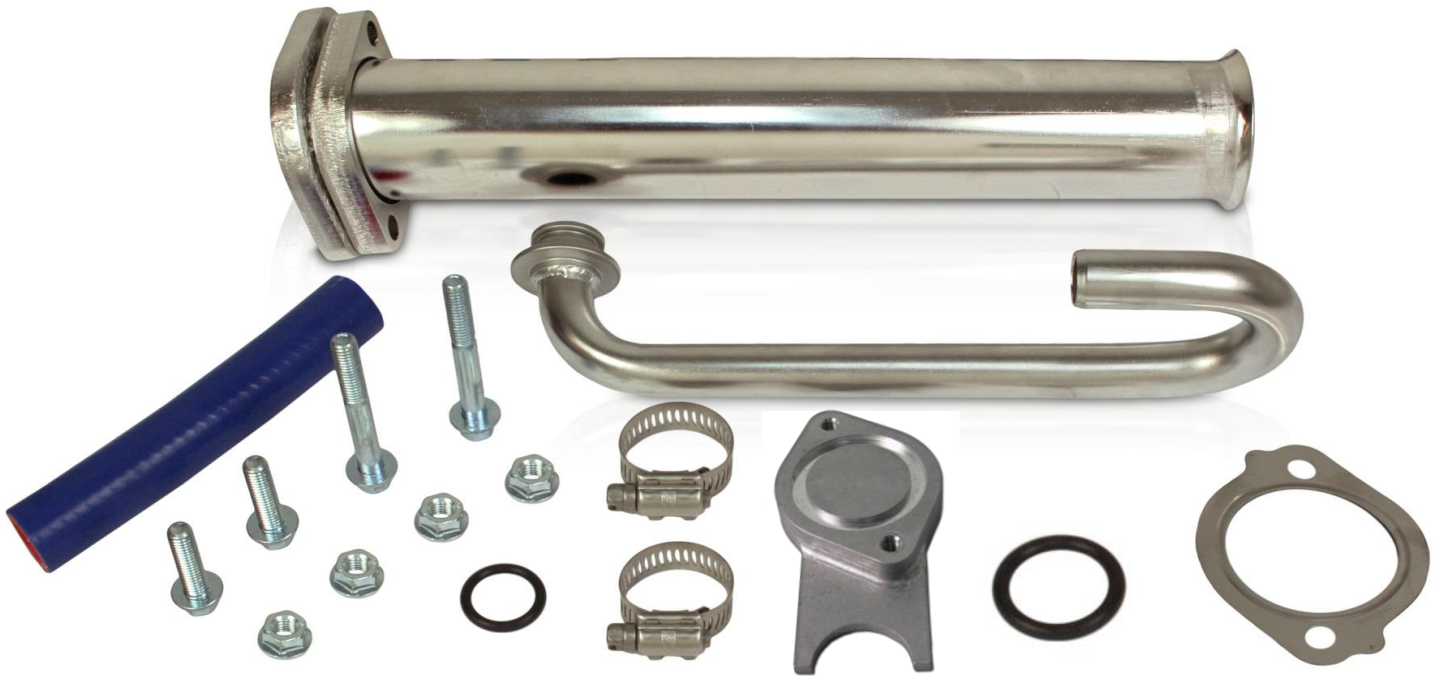

***This kit is for temporary use only.***

**K I T C O N T E N T S :**

Please check to make sure that you have all the parts listed in this kit **before** you start the disassembly of your truck.

Ford 2003 – 2007 6.0L EGR DELETE KIT (# 1090001)				
1900010-V2	1900011	1900012		
				
Aluminum Plate	EGR Coolant Tube	EGR Up Pipe		
Qty: 1	Qty: 1	Qty: 1		
1900022	1400283	1900005	1900016	1452821
				
Silicone Heater Hose, 5/8"	O-Ring, Viton 19mm X 3.53mm	Gasket, Passenger Side Up Pipe	Aluminum Plate O-ring	Hose Clamp (HS8)
Qty: 5"	Qty: 1	Qty: 1	Qty: 1	Qty: 2
1900015	1900014	1900013		
				
Flange bolt 30 mm Long	Flange nut	Flange bolt 60 mm Long		
QTY: 2	QTY: 4	QTY: 2		

Ford 2003 – 2007 6.0L EGR DELETE KIT (# 1090006)			
1900010-V2		1900011	1900017
			
<i>Aluminum Plate</i>		<i>EGR Coolant Tube</i>	<i>Pipe Cap</i>
Qty: 1		Qty: 1	Qty: 1
1900022	1400283	1900016	1452821
			
<i>Silicone Heater Hose, 5/8"</i>	<i>O-Ring, Viton 19mm X 3.53mm</i>	<i>Aluminum Plate O-ring</i>	<i>Hose Clamp (HS8)</i>
Qty: 5"	Qty: 1	Qty: 1	Qty: 1

**NOTE:** YOU MAY FIND IT ACCEPTABLE TO REUSE YOUR EXISTING INTAKE MANIFOLD GASKETS BUT WE STRONGLY RECOMMEND THE USE OF NEW GASKETS WHERE APPLICABLE.

OEM Ford Part #	Description
3C3Z-9433-BE	Intake Manifold Gasket Kit
9T515	Turbo Oil Drain Gaskets
9P455	EGR Valve Gasket
W302725	CC Vent Pipe on Valve Cover
<i>Parts available through your local Ford dealer</i>	

*Please note:* Depending on the application you will need a rivet gun and two 3/16" X 1/4" large head rivets to complete the attachment of the heat shield.

### **BATTERY DISCONNECT**

Record radio settings then disconnect the negative terminals on both of the vehicle's batteries.

## INSTALLATION

Drain engine coolant.

Remove engine coolant reservoir bottle mounting bolts and disconnect two (2) small hoses. Move the bottle to the side and tie secure in place.



Remove the air cleaner assembly by disconnecting the MAF sensor and Filter Mind device. Then remove the ribbed hose, then the air box. Remove the two (2) 8mm bolts securing the hard tube. Then remove the breather tube from the vent on the driver side rocker cover. (NOTE: Wiggling and pulling out on the tube will help in removal).

Remove the Intercooler air to air and the turbo inlet air tubes.

Remove the top section of the fan shroud which covers the serpentine belt.

Loosen the belt tensioner and remove the alternator.





Remove the oil filter and EGR valve and service both as required.



Disconnect the fuel filter wiring connectors and fuel lines then remove fuel filter housing.



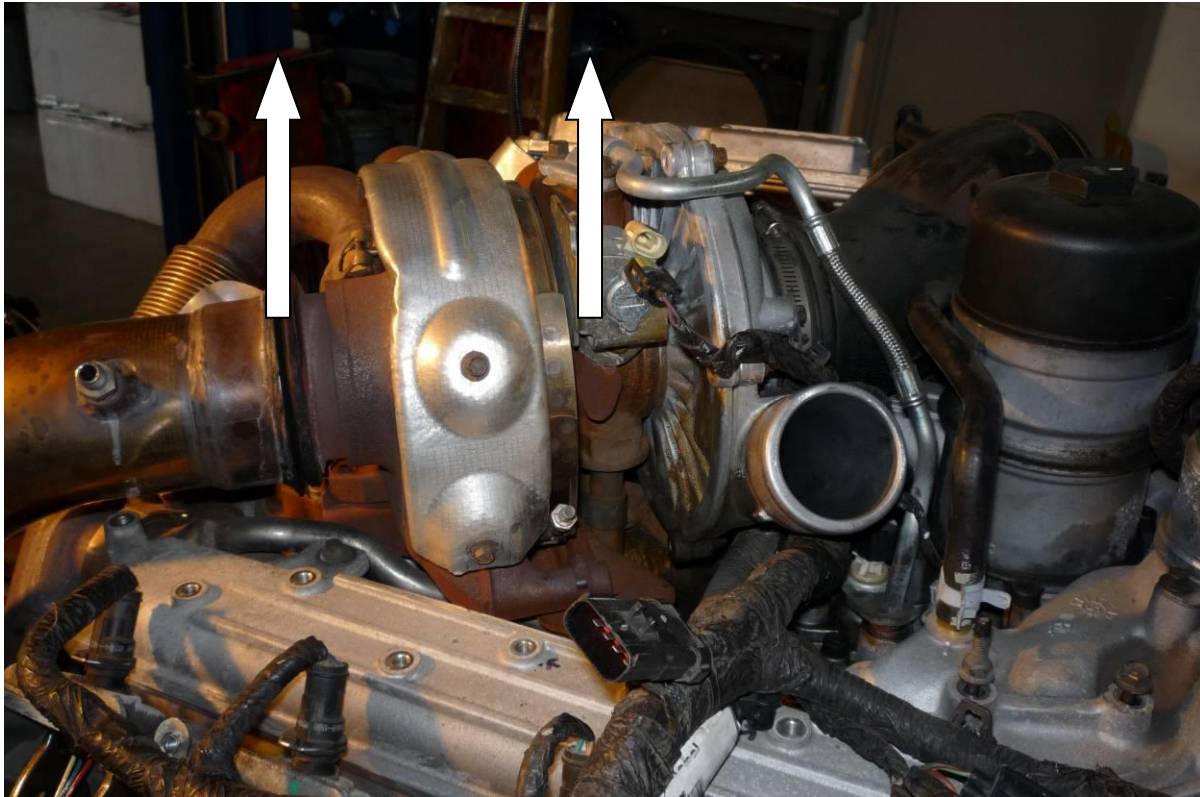

Remove the turbo charger by disconnecting the connector on the turbo solenoid and clip, the oil feed link, exhaust downpipe, and exhaust feed pipe clamp. Remove the three (3) 10mm mounting bolts and pull turbo out.

Remove the turbo pedestal mount by removing the four (4) 10mm mounting bolts and then remove the oil drain pipe.

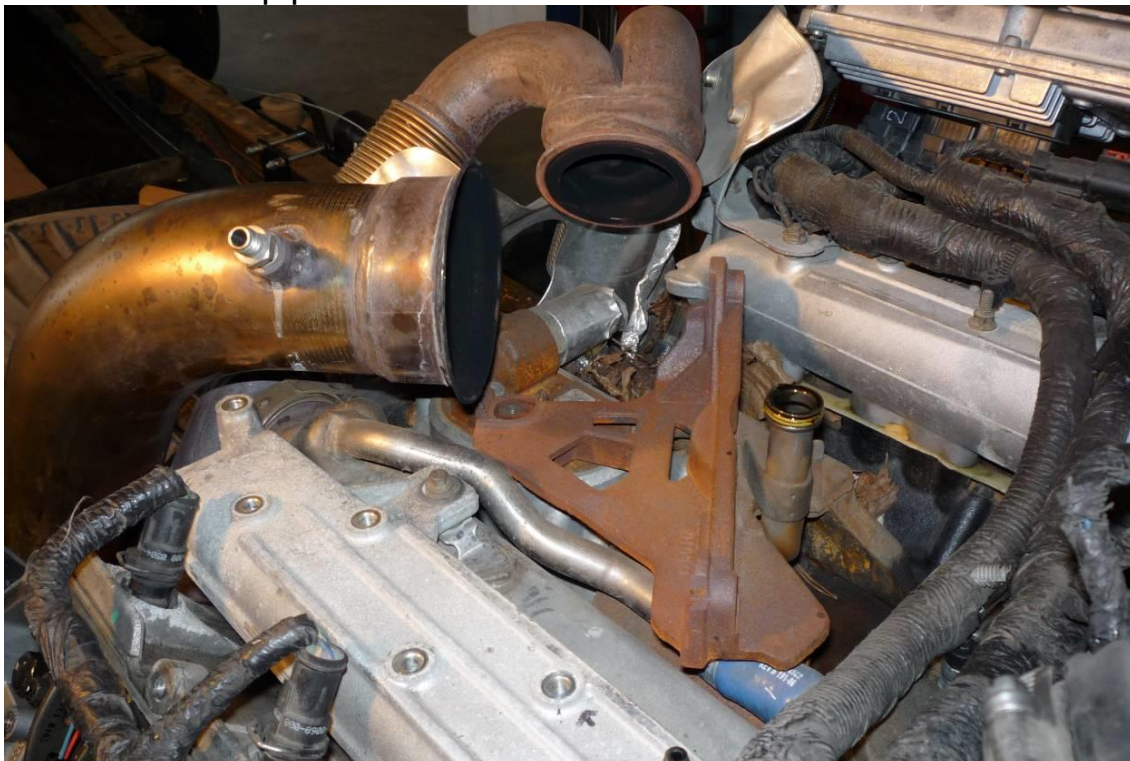

Remove the FICM (Fuel Injection Control Module) by removing two (2) 10mm mounting nuts and two (2) 8mm bolts. Disconnect the three (3) electrical plugs from the wiring harness.

Unplug and remove the fuel injector wiring harness.

Unplug the engine wiring harness from the sensors and tie the harness out of the way.



**NOTE:** Bend back the tab on the rigid metal tube at the RH side of intake manifold to allow manifold to clear.

Remove the intake manifold by removing the two (2) 15 mm bolts through the shroud to the front of the intake. Remove one (1) 10mm bolt securing the fuel line to the front of the intake. Remove one (1) 8mm bolt at the back of the EGR cooler and two (2) 10mm bolts at the front of the EGR cooler by accessing them through the intake manifold. Remove the 10mm bolts securing the intake manifold and remove the manifold. (Clean carbon from manifold as required)





Remove the EGR cooler by disconnecting the clamp at the exhaust feed pipe then remove the coolant hose by first cutting the front clamp then twisting to align the release tab and pulling (you may have to spread the tab with a small pick or screwdriver).

Disconnect the passenger side exhaust feed pipe by removing the two (2) 10mm bolts with 13mm nuts at the top and bottom and remove feed pipe. Some models require the heat shield rivets to be drilled out to remove the heat shield and access the 10mm bolts.

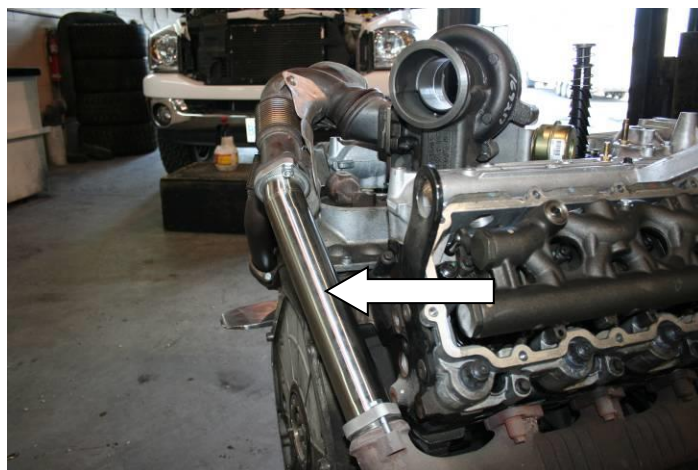
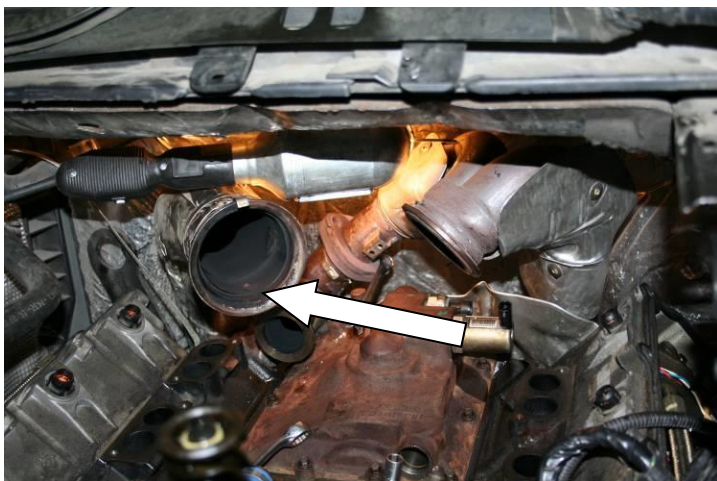

Loosen the driver's side exhaust feed pipe hardware at the manifold.



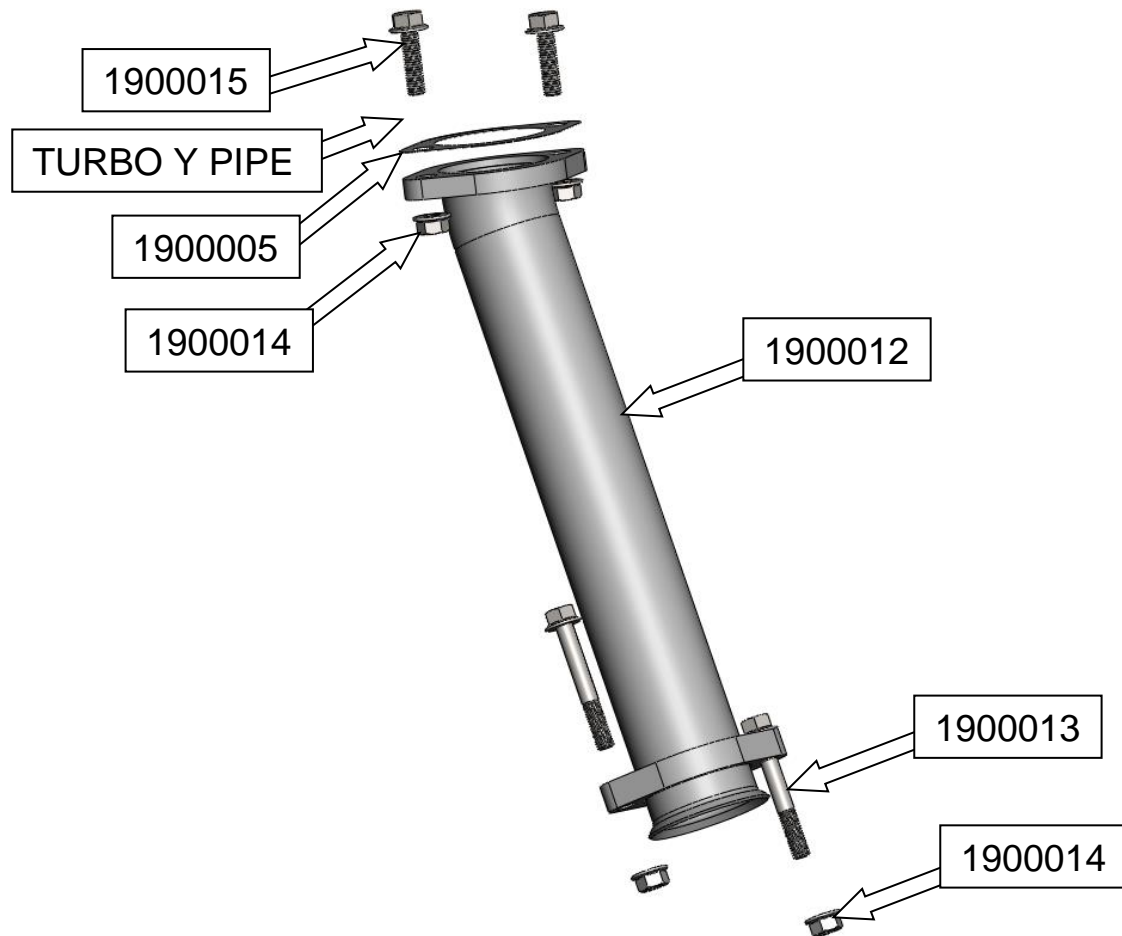

Install the newly supplied passenger side feed pipe using the supplied hardware. Install the supplied gasket (#1900005) on the top side of the pipe. Tighten the four nuts (13 mm socket) to 20 ft lbs. Reinstall the heat shield with new rivets if applicable. Install the lower mounting hardware at the manifold leaving loose.

The second option is capping the passenger side up-pipe EGR port using supplied cap (1900017) and OEM v-band. For this option, kit 1090006 is prepared.



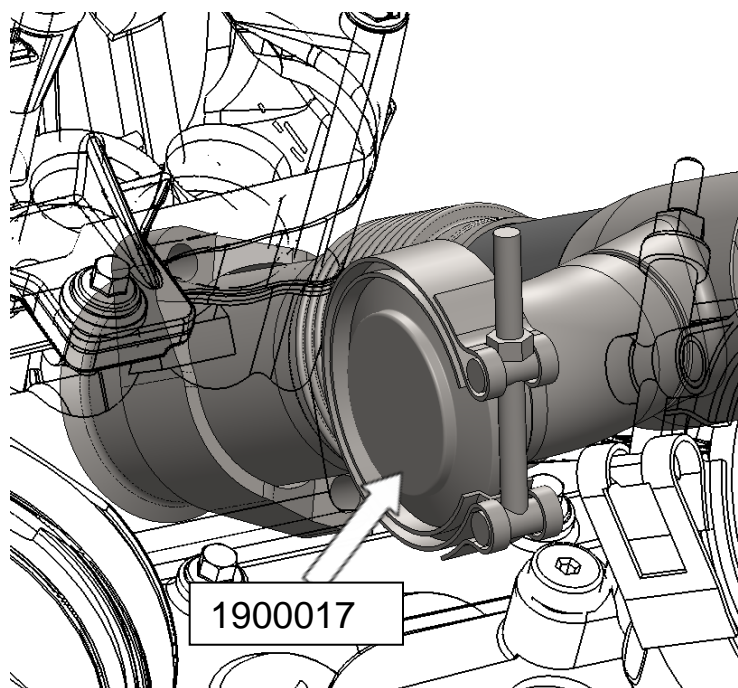

Place the cap using v band clamp on the EGR port and tighten the v-band clamp nut 6 N-m (53 lb-in)



Install newly supplied (#1400283) O-ring on the EGR Cooler Bypass Pipe then install pipe into the bottom of the intake. Install supplied oring (**#1900016**) into the blocker plate (1900010-V2) and install with the cooler bypass pipe over the exhaust port and tighten to 100 inch lbs of torque. (NOTE: This plate secures the



new pipe in place).

Install new intake manifold gaskets and intake manifold and tighten mounting bolts in

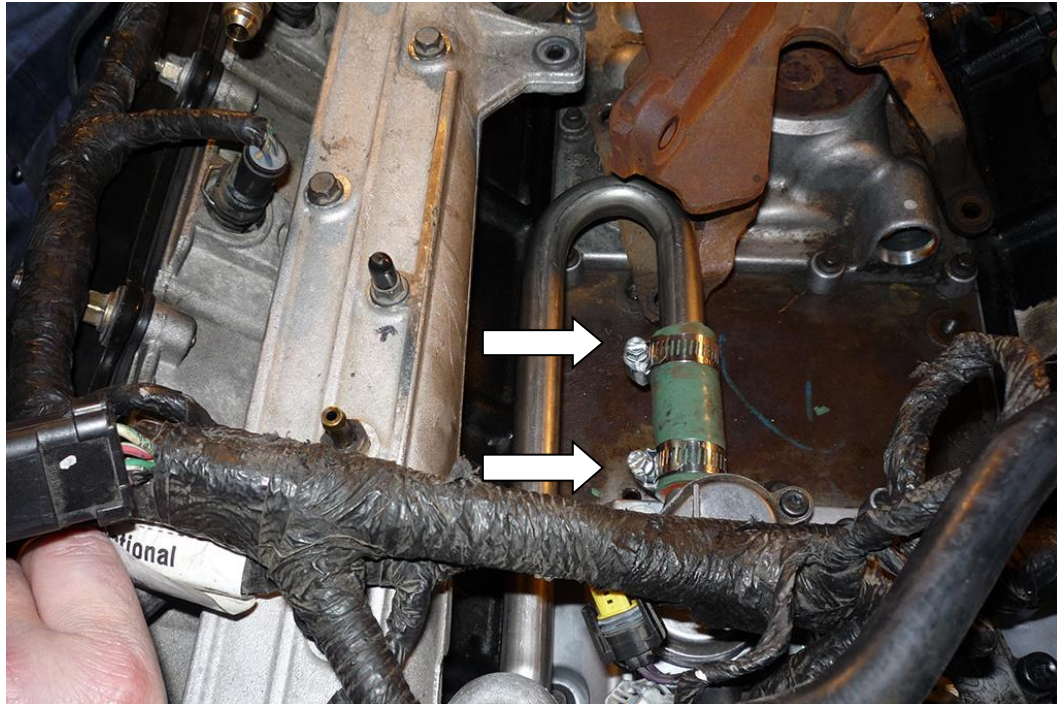

two (2) steps. 1 - Starting at the front and working towards the back, tighten bolts to 50 inch lbs of torque, then 2 - again starting at the front and working toward the back, tighten bolts to 100 inch lbs. Then install, at the front of the intake, two (2) 15mm bolts and torque to 23 ft lbs and one (1) 10mm bolt to 18 ft lbs. Install the silicone coolant hose with two (2) HS10 hose clamps (P/N 1453113).

**NOTE:** Ensure hose clamp screws are installed to the outside as turbo pedestal will NOT fit otherwise.

Install the turbo charger pedestal mount and torque to 23 ft lbs.



Install turbo oil drain with new O-rings.

Reconnect the engine wiring harness and injector wiring harness.

Install turbo charger. (NOTE: The three (3) mounting bolts should be left loose initially). Next firmly connect the feed pipe and exhaust down pipe, then adjust and torque the exhaust feed pipe hardware at the manifold to 20 ft lbs. Then torque the downpipe and feed pipe clamps at the turbo to 89 inch lbs and torque the turbo bolts to 23 ft lbs.

Re-install EGR Valve, Alternator, Fan Shroud, FICM and Intercooler air to air tubes.

Re-install Air Intake tubes and box. (NOTE: Replace O-ring on vent pipe into Valve Cover)

Mount coolant bottle and reconnect the small hoses. Fill system with coolant.

Re-connect batteries.

Start engine and check for leaks.

Road test vehicle and then check for leaks again. Top up coolant and engine oil as required.